

Thank you for purchasing this Cobra Dynojet kit. This kit has been developed for a motorcycle which is set to the parameters listed at the right in the "Stage" description. If your motorcycle does not meet any of these parameters please check with Dynojet before installation. For technical assistance contact your Dynojet distributor or call Dynojet U.S.A. (800)-992-4993

Cobra Engineering
 23801 E. La Palma Ave.
 Yorba Linda, CA. 92887
 TEL: 714-692-8180
 FAX: 714-692-5016

Website Address
<http://www.dynojet.com>

COBRA[®]
Anything's Possible

92-2169

U.S Models Only

*1996-2001 Yamaha XVZ1300A
 Royal Star
 Stage 1*

For mildly tuned machines using the stock
 airbox, with stock filter and Cobra Boulevard
 exhaust system

WARNING

**NO SMOKING!
 NO OPEN FLAME!
 WHILE INSTALLING
 YOUR DYNOJET KIT**

The manufacturer and seller make no warranties express or implied which extend beyond the description of the goods contained herein. Any description of this product is for the purpose of identifying it and shall not be deemed to create an express warranty.

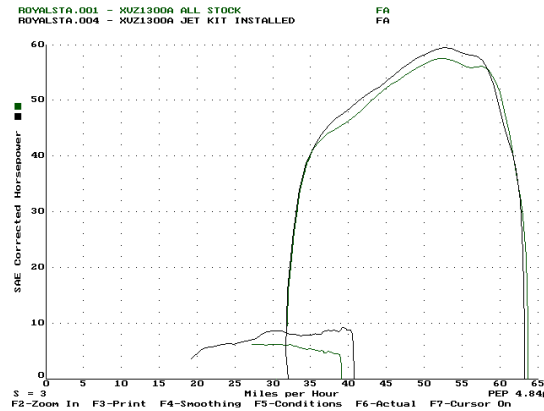

This graph shows a typical gain with a Cobra jet kit.

Parts List

| | | |
|---|------------------|----------|
| 4 | Fuel Needle | DNO470 |
| 4 | E-Clip | DE0001 |
| 4 | Adjusting Washer | DW0001 |
| 4 | Slide Springs | DSP009 |
| 1 | Plug Drill | DD #5/32 |
| 1 | Screw | DS0001 |

*For racing use only. Not for sale in the State of California.

STAGE ONE INSTRUCTIONS

COBRA

92-2169

NOTE: It is not necessary to remove the carburetors from this bike to install this kit.

1. Remove the vacuum slides from the carbs. Remove the stock needles and spacers noting order of assembly (Fig.A).
2. Install the Cobra needles on groove #3. Use all stock spacers (Fig. A). Install the Cobra washers above the e-clip. Install the Cobra slide springs (DSP009) in place of the stock springs.
3. Use the stock main jets.
4. Locate the fuel mixture plug (Fig. B), if you see a screw head at Fig. B proceed to the adjusting procedure. With the 5/32 drill provided, carefully drill through the plug. **NOTE:** The mixture screw is directly underneath this plug, be ready to pull back on the drill the instant you break through. Use screw provided to secure and remove this plug. Carefully turn mixture screw in until lightly seated, then back out 3.5 turns.

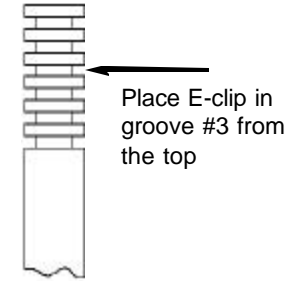

Fig. A

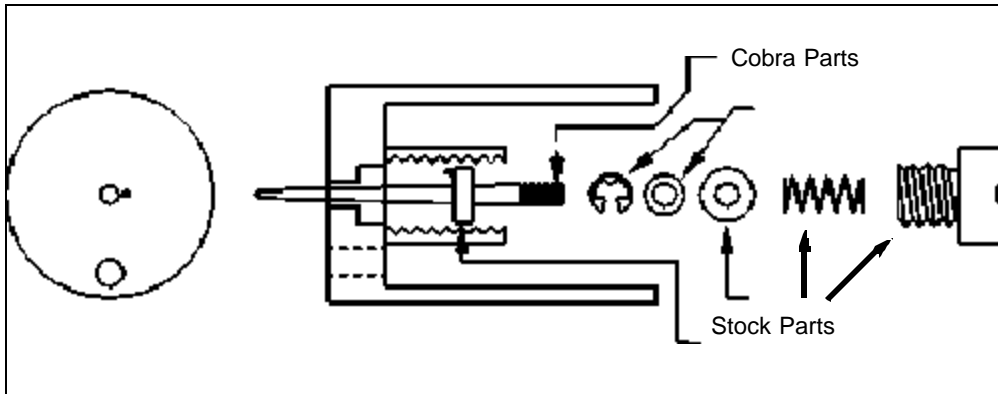

Fig. B

