

Thank you for purchasing this Cobra Dynojet kit. This kit has been developed for a motorcycle which is set to the parameters listed at the right in the "Stage" description. If your motorcycle does not meet any of these parameters please check with Dynojet before installation. For technical assistance contact your Dynojet distributor or call Dynojet U.S.A. (800)-992-4993

Cobra Engineering
 23801 E. La Palma Ave.
 Yorba Linda, CA. 92887
 TEL: 714-692-8180
 FAX: 714-692-5016

Website Address
<http://www.dynojet.com>

The manufacturer and seller make no warranties express or implied which extend beyond the description of the goods contained herein. Any description of this product is for the purpose of identifying it and shall not be deemed to create an express warranty.

COBRA[®]
Anything's Possible

92-2166
 U.S Models Only

1988-2000 Yamaha XV1100
 Virago

Stage 1

For mildly tuned machines using the stock airbox, with stock filter and Cobra Boulevard exhaust system

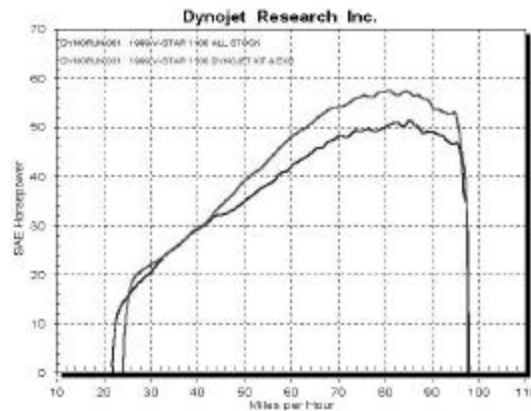

This graph shows a typical gain with a Cobra jet kit.

WARNING

**NO SMOKING!
 NO OPEN FLAME!
 WHILE INSTALLING
 YOUR DYNOJET KIT**

Parts List

2	Main Jet	DJ110
2	Main Jet	DJ114
2	Fuel Needle	DNT721
2	Adjusting Washer	DW0001
2	E-clips	DE0001
1	Plug Drill	DD #5/32
1	Screw	DS0001

*For racing use only. Not for sale in the State of California.

STAGE ONE INSTRUCTIONS

COBRA

92-2166

NOTE: It is not necessary to completely remove the carburetors from the motorcycle to install this kit.

1. Remove the vacuum slides from the carbs. Remove stock needles and spacers noting order of assembly (Fig.A).
2. Install Cobra needles on groove #4. Use all stock spacers (Fig. A). Install the Cobra washers above the e-clip.
3. It is not necessary to remove the float bowls to change the main jets. Remove the float bowl drain plugs and loosen the main jet with a stubby screwdriver. Use a toothpick to unscrew the jet. Remove the stock main jets and replace with the Cobra main jets provided. Use the DJ114 main jets at altitudes below 3000 feet. Use the DJ110 main jets at altitudes above 3000 feet. Be sure that the jet you are changing is the main jet.
4. Locate the fuel mixture plug (Fig. B), if you see a screw head at Fig. B proceed to the adjusting procedure. With the 5/32 drill provided, carefully drill through the plug. **NOTE:** The mixture screw is directly underneath this plug, be ready to pull back on the drill the instant you break through. Use screw provided to secure and remove this plug. Carefully turn mixture screw in until lightly seated, then back out 1.5 turns.

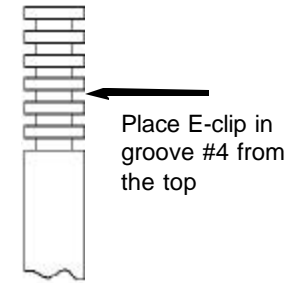

Fig. A

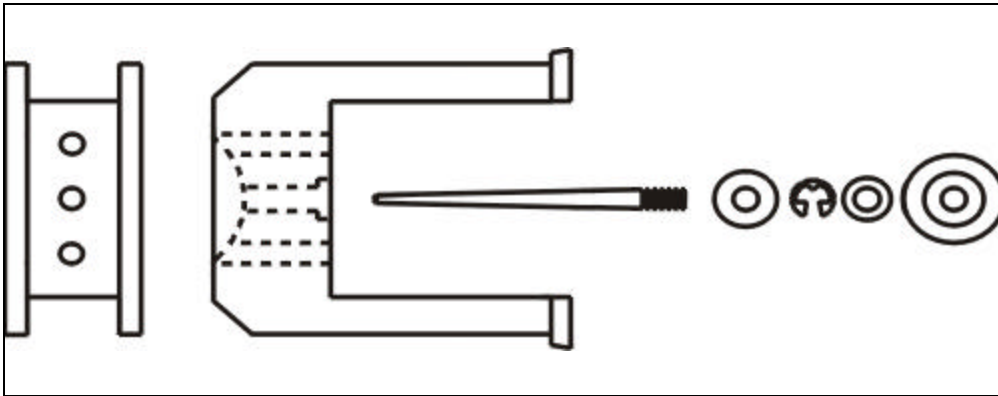

Fig. B

