

Thank you for purchasing this Cobra Dynojet kit. This kit has been developed for a motorcycle which is set to the parameters listed at the right in the "Stage" description. If your motorcycle does not meet any of these parameters please check with Dynojet before installation. For technical assistance contact your Dynojet distributor or call Dynojet U.S.A. (800)-992-4993

Cobra Engineering
23801 E. La Palma Ave.
Yorba Linda, CA. 92887
TEL: 714-692-8180
FAX: 714-692-5016

Website Address
<http://www.dynojet.com>

The manufacturer and seller make no warranties express or implied which extend beyond the description of the goods contained herein. Any description of this product is for the purpose of identifying it and shall not be deemed to create an express warranty.

COBRA[®]
Anything's Possible

92-1274
U.S Models Only
2001-05 Honda VT750
Spirit
Stage 1

For mildly tuned machines using the stock airbox, with stock filter and Cobra Boulevard exhaust system

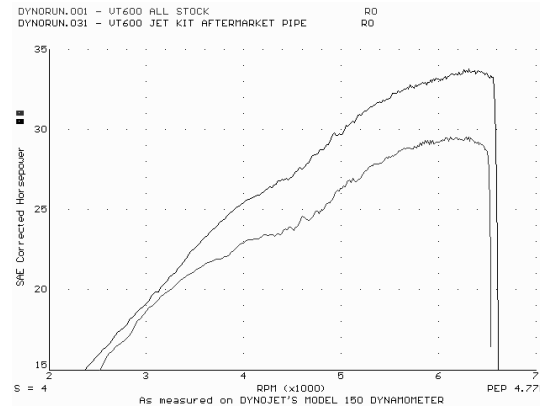

This graph shows a typical gain with a Cobra jet kit.

WARNING

**NO SMOKING!
NO OPEN FLAME!
WHILE INSTALLING
YOUR DYNOJET KIT**

Parts List

1	Main Jet	DJ098
1	Main Jet	DJ100
1	Main Jet	DJ102
1	Main Jet	DJ104
1	Main Jet	DJ106
2	Fuel Needles	DNO114
2	Slide Springs	DSP044
2	E-Clips	DE0001
2	Adjusting Washers	DW0001
1	Plug Drill	DD #5/32
1	Screw	DS0001

STAGE ONE INSTRUCTIONS

1. Remove vacuum slides from carbs. Remove stock needles and spacers, noting order of assembly (Fig. A).
2. Install the Cobra needles on groove # 3 from the top (Fig. A). Install the small Dynojet washers above the E-clip.
3. Install the Cobra slide spring provided (DSP044) in place of the stock slide spring. After installing the slides in the carbs be sure to check slide movement manually.
4. Remove the stock main jets and replace with the Cobra main jets provided. If you are running the Cobra Classic exhaust, Drag pipes with out baffles or the Streetrod exhaust use the DJ104 main jet in the front (right) carburetor and the DJ106 main jet in the rear (left) carburetor. When running Cobra Drag pipes with baffles use the DJ102 main jet in the front (right) cylinder and the DJ104 main jet in the rear (left) cylinder.
5. Locate the fuel mixture plug (Fig. B). If you see a screw head at Fig. B proceed to the adjusting procedure. With the 5/32 drill bit provided, carefully drill through the plugs. **Note:** The mixture screw is directly underneath this plug, be ready to pull back on the drill the instant you break through. Use screw provided to secure and remove this plug. Carefully turn mixture screws clockwise until lightly seated. Turn the screw in until lighty seated then back out 3 turns.

COBRA

92-1274

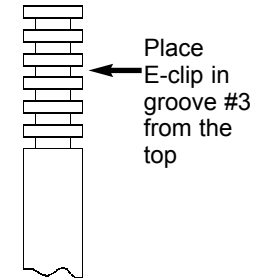

Fig. A

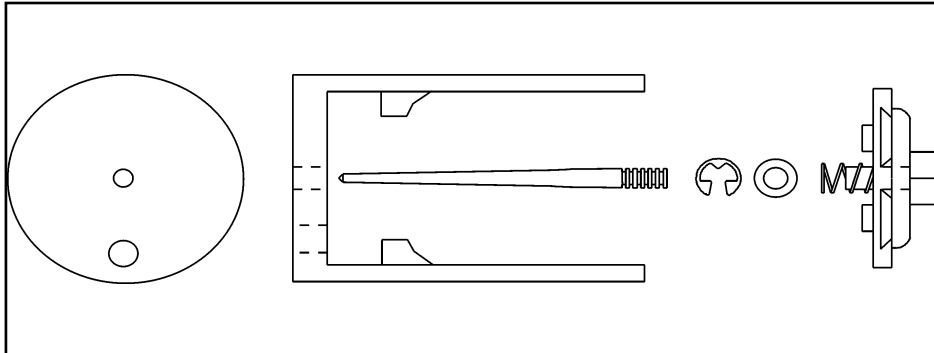
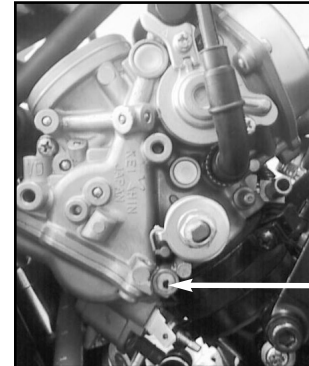

Fig. B



Mixture Screw Location