

Thank you for purchasing this Cobra Dynojet kit. This kit has been developed for a motorcycle which is set to the parameters listed at the right in the "Stage" description. If your motorcycle does not meet any of these parameters please check with Dynojet before installation. For technical assistance contact your Dynojet distributor or call Dynojet U.S.A. (800)-992-4993

Cobra Engineering  
23801 E. La Palma Ave.  
Yorba Linda, CA. 92887  
TEL: 714-692-8180  
FAX: 714-692-5016

Website Address  
<http://www.dynojet.com>

The manufacturer and seller make no warranties express or implied which extend beyond the description of the goods contained herein. Any description of this product is for the purpose of identifying it and shall not be deemed to create an express warranty.



92-1269

U.S. Models Only

1997-2003 Valkyrie

Stage 1

For mildly tuned machines using the stock  
airbox, with stock filter and Cobra Boulevard  
exhaust system

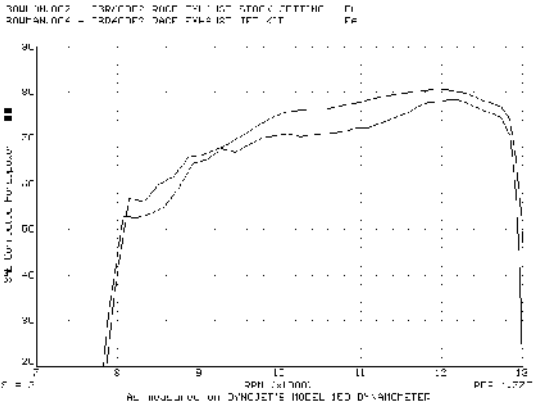

This graph shows a typical gain with a Cobra jet kit.

# WARNING

**NO SMOKING!  
NO OPEN FLAME!  
WHILE INSTALLING  
YOUR DYNOJET KIT**

## Parts List

6	Fuel Needle	DNO675
6	E-Clips	DE0001
6	Adjusting Washers	DW0001
6	Slide Springs	DSP007
1	Idle Adjustment Tool	DT008

\*For racing use only. Not for sale in the State of California.

## STAGE ONE INSTRUCTIONS

1. Remove the carb top and slide spring. Remove the slide by threading one of the slide cover screws into the center of the needle retainer (Fig. A) and pull up gently. Remove the stock needles and spacers, noting order of assembly (Fig. B).
2. Install the Cobra needles on groove #3 from the top. Use all stock spacers (Fig. B). Install the small Cobra washers above the E-clip.
3. Install the stock needle retainers with the Cobra slide springs (DSP007). After installing the slides in the carbs be sure to check slide movement manually.
4. Locate the fuel mixture tab (Fig. C). Using the tool supplied (DT008), carefully turn the tabs clockwise until they lightly seat and then back out 2.5 turns.

**COBRA**

**92-1269**

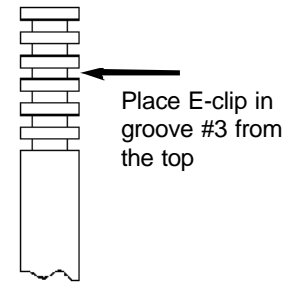

Fig. A

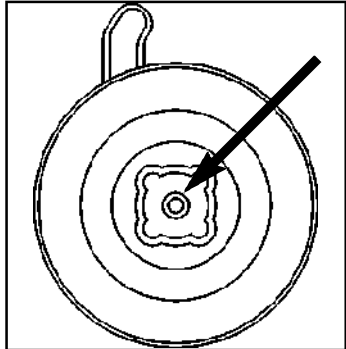

Fig. B

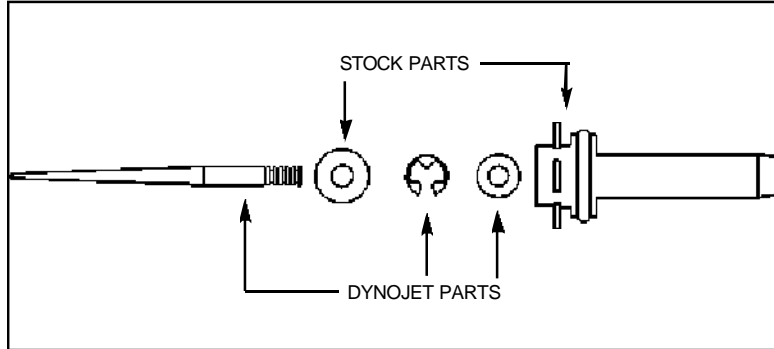

Fig. C

