

Thank you for purchasing this Cobra Dynojet kit. This kit has been developed for a motorcycle which is set to the parameters listed at the right in the "Stage" description. If your motorcycle does not meet any of these parameters please check with Dynojet before installation. For technical assistance contact your Dynojet distributor or call Dynojet U.S.A. (800)-992-4993

Cobra Engineering  
 23801 E. La Palma Ave.  
 Yorba Linda, CA. 92887  
 TEL: 714-692-8180  
 FAX: 714-692-5016

Website Address  
<http://www.dynojet.com>

The manufacturer and seller make no warranties express or implied which extend beyond the description of the goods contained herein. Any description of this product is for the purpose of identifying it and shall not be deemed to create an express warranty.

**COBRA**<sup>®</sup>  
*Anything's Possible*

**92-1263**

U.S Models Only

2004-2008 Honda  
 VT750 AERO

**Stage 1**

For mildly tuned machines using the stock airbox, with stock filter and Cobra Boulevard exhaust system

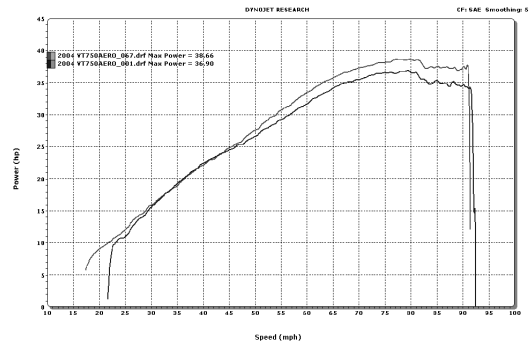

*This graph shows a typical gain with a Cobra jet kit.*

**WARNING**

**NO SMOKING!  
 NO OPEN FLAME!  
 WHILE INSTALLING  
 YOUR DYNOJET KIT**

**Parts List**

1	Main Jet	DJ112
1	Main Jet	DJ116
1	Main Jet	DJ120
1	Fuel Needle	DNO767
1	Adjusting Washer	DE0001
1	E-clip	DW0001
1	Tool	DT009

**STAGE ONE INSTRUCTIONS**

1. Remove the vacuum slide from the carb. Remove the stock needle and spacers, noting the order of assembly (Fig. A).
2. Install the Cobra needle on groove #1 from the top. Use all stock spacers (Fig. A). Install the small Cobra washer above the E-clip. After installing the slide in the carb, be sure to check slide movement manually before air box installation.
3. Remove the stock main jet and replace with the Cobra main jet provided. Use the DJ116 main jet at altitudes below 3000 feet and use the DJ112 main jet at altitudes above 3000 feet. Be sure that the jet you are changing is the main jet.
4. Locate the fuel mixture screw (Fig. B). Using the tool provided (DT009), carefully turn the mixture screws clockwise until lightly seated, then turn back out 2 turns.

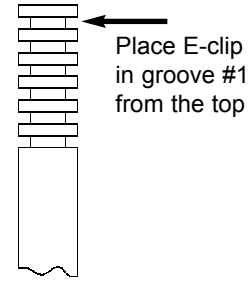
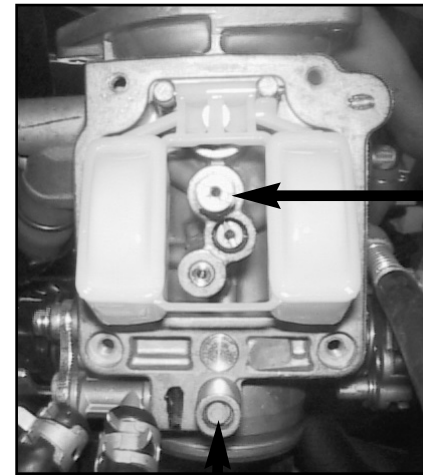
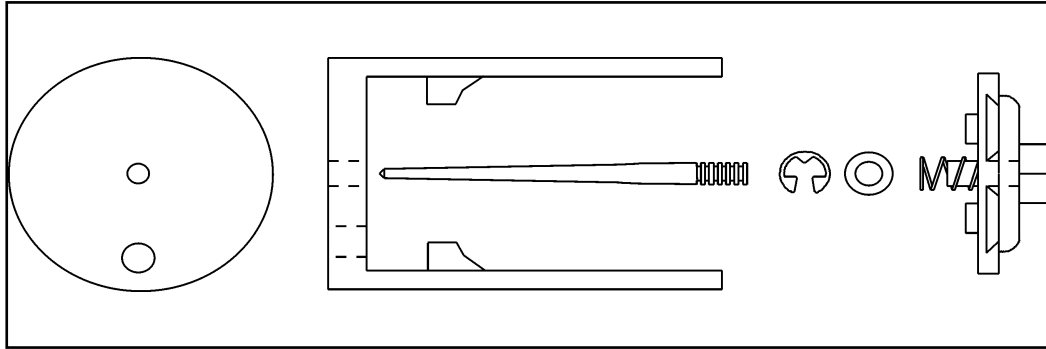

Fig. B

Fig. A



Main jet location

Mixture Screw