

## Items Supplied >

- 1 – Assembled Lightbar
- 2 – Bolt, Buttonhead M8 x 55mm
- 2 – Spacer, Zinc Plated Steel
- 2 – Terminal, Push On
- 1 – Black Power Wire W/Blue Quick Splice Connector
- 3 – Zip Ties

## Application(s) >

HONDA AERO 750      04-09, 11-14

## Instruction Manual >

04-0118

Page 1 of 2

**Read your installation instructions completely before beginning. This light bar can be installed in just a few minutes using common tools. It is recommended however, that a qualified mechanic or technician install this product.**

1. Remove the two Phillips screws from headlight and set aside. Remove headlight from housing, unplug and set aside.
2. Locate left and right turn signal wires inside the headlight housing and disconnect.
3. Remove the two M8 bolts & nuts from headlight housing and lower triple clamp and set aside.
4. Remove the four M6 Phillips head screws from the turn signal mounting bar. Remove the turn signals from the bar. Remove the bracket and M6 bolt from both turn signals.
5. Install the turn signals onto the Cobra light bar, be sure to install the turn signals on the side they were taken from, with the M6 allen bolts removed in Step 4, see Figure 1. Be careful not to pinch the wires.
6. Install the new M8 x 55mm flange bolts thru the top of the headlight housing and the triple clamp.
7. Install Cobra lightbar under the lower triple clamp by first sliding the spacers provided over the M8 bolts protruding through the bottom of triple clamp, then the light bar followed by the M8 nuts removed in step 3.
8. Align lightbar and headlight housing then tighten the nuts according to factory torque specifications.
9. Rotate spotlights forward then align and tighten.
10. Route the left and right turn signal harnesses thru the back of the headlight housing and connect them back into their original connector.
11. Route the left spotlight wire under the lightbar towards the light bar switch, take right spotlight wire and twist together with the left one. Insert the two (twisted together) wires into the supplied push on terminal and crimp with a crimping tool. Connect this to one of the poles on the lightbar switch, it does not matter which one.
12. Connect the 20" power wire to the remaining pole on the lightbar switch. Route power wire through the back of the headlight housing. Loosely pull slack out of wire and using the 3 supplied zip ties wrap spotlight, turn signals, and power wire to the lightbar.
13. Locate the three prong accessory connector with the blue, brown and green wires in the head light housing (it has nothing connected to it). On 2004-2007 models connect the **Black** power wire from the lightbar switch to the **Blue** wire using the supplied (blue) quick splice connector. On 2008 models connect the **Black** power wire from the lightbar switch to the **Brown** wire on the three prong accessory connector.
14. Reinstall headlight with the two Phillips screws removed in step 1.
15. Check to make sure your handlebars turn from lock to lock without any stretching or binding of any wires. Check the alignment of all your lighting. Make sure everything is in proper working order before riding vehicle.

**\* Cobra® recommends you always wear a helmet while riding. Please never operate your motorcycle while under the influence of alcohol and/or drugs. Enjoy the new look of your motorcycle and please ride safely.**

**CAUTION!**  
DO NOT PINCH  
TURNSIGNAL WIRE  
WHEN TIGHTENING  
BOLT

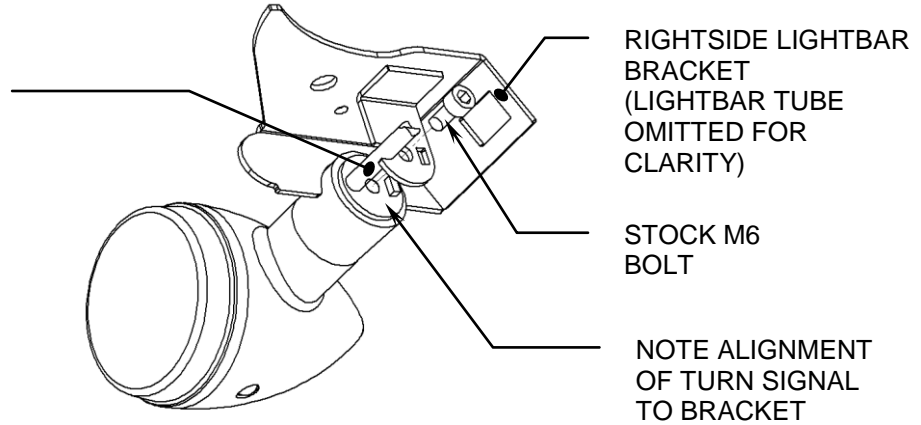

FIGURE 1

\* Cobra recommends you always wear a helmet while riding. Please never operate your motorcycle while under the influence of alcohol and/or drugs. Enjoy the new look of your motorcycle and please ride safely.