



Items Supplied >

DESCRIPTION:	QUANTITY:
1. Freeway Bar	x1
2. Left Frame Bracket	x1
3. Right Frame Bracket	x1
4. M8 x 16mm Flanged Bolt	x2

Application(s) >

MAKE:	MODEL:	YEAR:
HONDA	REBEL 500	17-24

Instruction Manual >

01-1109B

Page 1 of 4

Read all instructions carefully before installing your new Cobra® product!

NOTE: Cobra Freeway Bars add style to your motorcycle. They are not designed to withstand a serious impact and may not protect you and/or your motorcycle in the event of a crash.

1. Remove any accessories that may prohibit the installation of your new freeway bar.
2. Cover the rear portion of the front fender with masking tape to prevent it from getting scratched during installation.
3. Remove the upper left-side engine mount bolt from the threaded boss on the motorcycle frame and set aside for reuse. See **FIGURE 1**.
4. Using the stock bolt removed in Step 3, install the provided left-side frame bracket onto the motorcycle by inserting the bolt through the slot in the bracket and into the threaded boss on the motorcycle frame. Make sure the PEM fastener is facing inwards and the rounded edge is facing up. See **FIGURE 2**. Snug the bolt but do not tighten at this time.

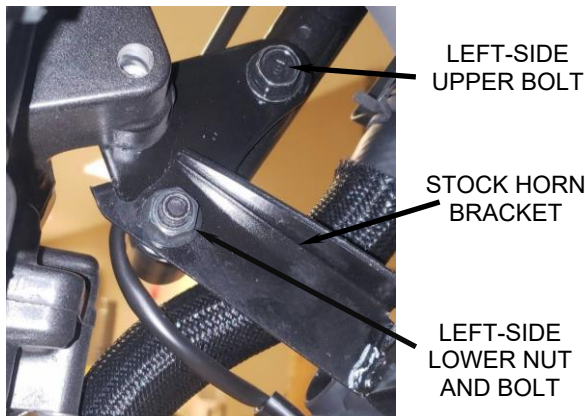

FIGURE 1
(VIEW FROM RIGHTSIDE OF BIKE)

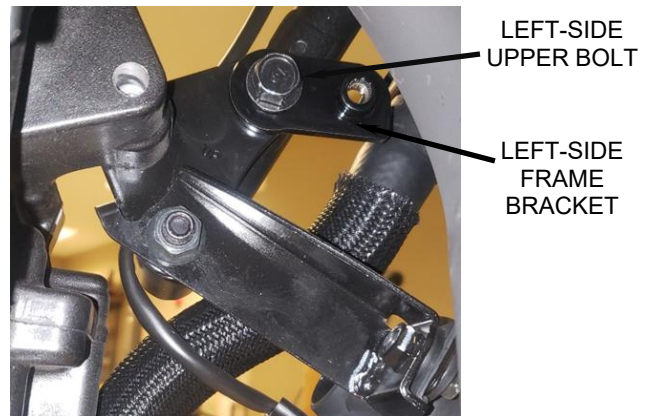

FIGURE 2
(VIEW FROM RIGHTSIDE OF BIKE)

CLEANING INSTRUCTIONS:

To clean your black freeway bars use a liquid based soap detergent, such as dishwashing soap applied with a soft cloth and rinse with clean water. **Note: Avoid abrasive cleaning methods such as granular or dry cleansers, simple green, Scotch-Brite or steel wool pads. Abrasives may breach the coating and shorten life.**

**Cobra® recommends you always wear a helmet while riding. Please never operate your motorcycle while under the influence of alcohol and/or drugs. Enjoy the new look of your motorcycle and please ride safely.*

5. Remove the upper right-side engine mount bolt from the threaded boss on the motorcycle frame and set aside for reuse. See **FIGURE 3**.
6. Using the stock bolt removed in Step 5, install the provided right-side frame bracket onto the motorcycle by inserting the bolt through the slot in the bracket and into the threaded boss on the motorcycle frame. Make sure the PEM fastener is facing inwards and the rounded edge is facing up. See **FIGURE 4**. Snug the bolt but do not tighten at this time. **Be mindful not to pinch the wire harness during installation.**
7. Remove both the left and right-side lower engine mount nuts and bolts from the motorcycle frame and set aside for reuse. Carefully let the horn and horn bracket hang loose for a moment. See **FIGURES 1, 3, 5, & 6**.
8. If possible, use an assistant to help hold the freeway bar during installation. Carefully position the freeway bar between the engine mounts and the front tire. Make sure not to capture or pinch any cables or wires with the freeway bar. Slide the lower freeway bar brackets over the outside of lower engine mounts and align the holes. **Be mindful of the radiator hose during installation.**
9. Insert the left-side stock bolt from Step 7 through the left-side lower freeway bar bracket, through the lower engine mount, through the stock horn bracket thread into the left-side stock nut. See **FIGURES 1 & 7**. Snug the nut and bolt but do not tighten at this time.



RIGHT-SIDE
UPPER BOLT

RIGHT-SIDE
LOWER NUT
AND BOLT

FIGURE 3
(VIEW FROM LEFT SIDE OF BIKE)



RIGHT-SIDE
UPPER BOLT

RIGHT-SIDE
FRAME
BRACKET

FIGURE 4
(VIEW FROM LEFT SIDE OF BIKE)



LEFT-SIDE
LOWER BOLT

FIGURE 5
(VIEW FROM LEFT SIDE OF BIKE)

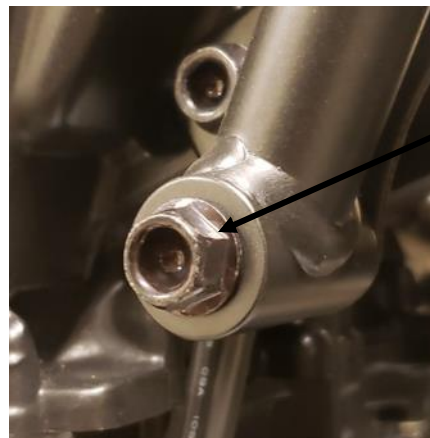

RIGHT-SIDE
LOWER BOLT

FIGURE 6
(VIEW FROM RIGHT SIDE OF BIKE)

10. Insert the right-side stock bolt from Step 7 through the right-side lower freeway bar bracket, through the lower engine mount, and into the left-side stock nut. See **FIGURES 3 & 8**. Snug the nut and bolt but do not tighten at this time.
11. Carefully rotate the top of the freeway bar towards the upper frame until the holes in the upper freeway bar brackets align with the PEM fasteners in the upper frame brackets. Insert one of the provided M8 x 16mm flanged bolts through the left-side upper freeway bar bracket and into the threaded PEM fastener of the left-side frame bracket. See **FIGURE 9**. Snug the bolt but do not tighten at this time.
12. Insert one of the provided M8 x 16mm flanged bolts through the right-side upper freeway bar bracket and into the threaded PEM fastener of the right-side frame bracket. See **FIGURE 10**. Snug the bolt but do not tighten at this time.
13. Make sure the freeway bar is positioned correctly and is square to the motorcycle and is not interfering with or pinching any cables or wires. Then fully tighten both the left and right-side lower stock nuts and bolts, followed by the left and right-side intermediate M8 x 16mm bolts, and finally the left and right-side upper stock bolts. Retighten all (6) bolts after the first ride, after the first 500 miles, and at every engine service thereafter.



FIGURE 7
(VIEW FROM FRONT LEFT OF BIKE)



FIGURE 8
(VIEW FROM FRONT RIGHT OF BIKE)



FIGURE 9
(VIEW FROM LEFT SIDE OF BIKE)



FIGURE 10
(VIEW FROM RIGHT SIDE OF BIKE)

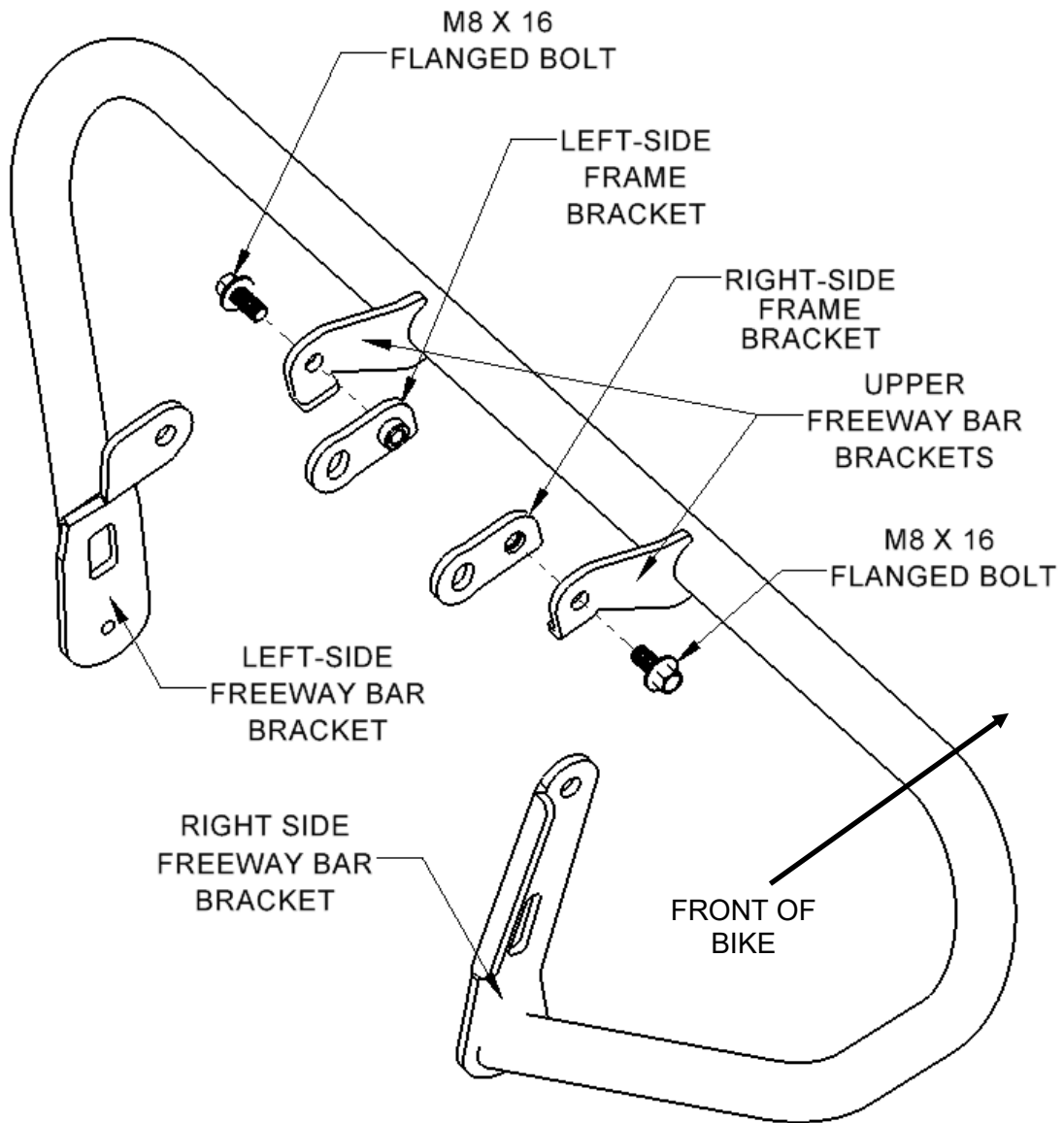

EXPLODED VIEW