

Thank you for purchasing this Cobra jet kit. This kit has been developed for a motorcycle which is set to the parameters listed at the right in the "Stage" description. If your motorcycle does not meet any of these parameters please check with Cobra before installation. For technical assistance contact Dynojet (800)-992-4993

Cobra Engineering  
23801 E. La Palma Ave.  
Yorba Linda, CA 92887  
TEL: 714-692-8180  
FAX: 714-692-5016

Website Address  
<http://www.cobrausa.com>

The manufacturer and seller make no warranties express or implied which extend beyond the description of the goods contained herein. Any description of this product is for the purpose of identifying it and shall not be deemed to create an express warranty.

**COBRA®**  
*Anything's Possible*

92-3267  
U.S Models Only

*2001-2004 Suzuki 800 Volusia*

**Stage 1**

For mildly tuned machines using the stock  
airbox, with stock filter and Cobra Boulevard  
exhaust system

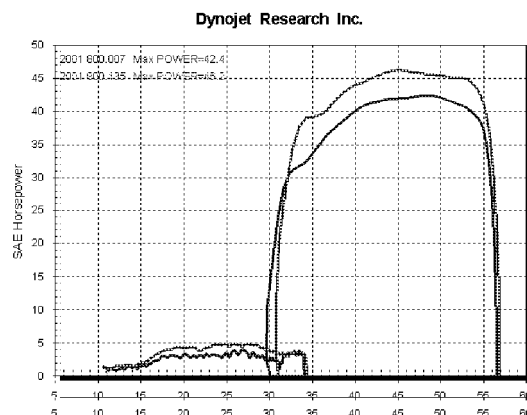

*This graph shows a typical gain with a Cobra jet kit.*

# WARNING

**NO SMOKING!  
NO OPEN FLAME!  
WHILE INSTALLING  
YOUR JET KIT**

## Parts List

1	Main Jet	DJ128
1	Main Jet	DJ130
1	Main Jet	DJ132
1	Fuel Needle	DNO712
1	E-Clip	DE0001
1	Adjusting Washer	DW0001
1	Slide Spring	DSP026
1	Plug Drill	DD #5/32
1	Needle Spring	DSP77
1	Screw	DS0001

\*For racing use only. Not for sale in the State of California.

## STAGE ONE INSTRUCTIONS

**COBRA**

**92-3267**

1. Remove the vacuum slide from the carburetor. Remove the stock needle and spacers, noting order of assembly (Fig. A).
2. Install the Cobra needle on groove #3 from the top using all stock spacers (Fig. A). **NOTE:** The DSP77 spring does not have to be used, it is supplied in case the stock spring is misplaced. The DW0001 does not have to be used, it is supplied for half step needle adjustments. After installing the slide in the carb be sure to check slide movement manually.
3. Remove the stock main jet and replace with the Cobra main jet provided. When using classic exhaust or drag pipes **WITHOUT** baffles use the DJ132 main jets. When using drag pipes **WITH** baffles use the DJ130 main jets. Be sure that the jet you are changing is the main jet.
4. Locate the fuel mixture plug (Fig. B). If you see a screw head at Fig. B proceed to adjusting procedure. With the 5/32 drill bit provided carefully drill through the plugs. **NOTE:** The mixture screw is directly underneath this plug, be ready to pull back on the drill the instant you break through. Use screw provided to secure and remove this plug. Carefully turn mixture screws clockwise until lightly seated, then back out 3.5 turns.

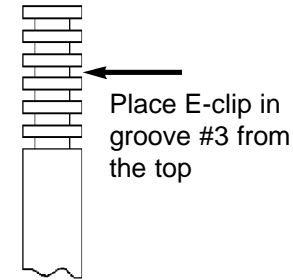

Fig. A

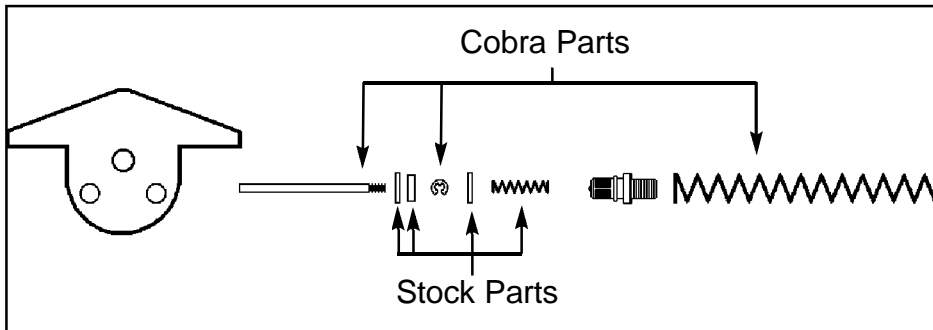
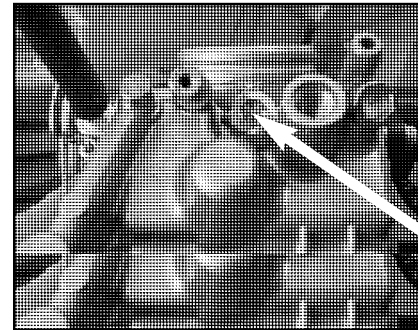

Fig. B



Mixture Screw Location