



Items Supplied >

1 – FRONT HEADPIPE W/HEATSHIELD
1 – REAR HEADPIPE W/HEATSHIELD
1 – MUFFLER ASSEMBLY
1 – EXHAUST MOUNT BRACKET
1 – BRAKE LINE BRACKET
2 – EXHAUST FLANGES
4 – SMALLER HOSE CLAMPS; 2 – LARGER HOSE CLAMPS
2 – CLAMP, 27-61MSC
2 – SPACERS
2 – BOLT, HEX 5/16-18 x 5/8
2 – BOLT, ALLEN M10x45mm
2 – NUT, M10 NYLOCK
1 – O₂ SENSOR HARNESS EXTENSION

Application(s) >

YAMAHA ROADSTAR 1700 08-13

Instruction Manual >

2223

Page 1 of 3

PRIOR TO INSTALLATION, MAKE SURE YOUR STOCK HEADPIPE GASKETS ARE IN GOOD SHAPE. IF YOU HAVE ANY DOUBTS AS TO THEIR CONDITION, REPLACE THEM.

Read all instructions carefully and completely before installing your new exhaust system

1. Loosen and move the right side floorboard out of the way to ease installation of the exhaust.
2. Remove the seat by turning the ignition key entirely to the left side. Remove the painted left then right side cover from behind the engine, secured with large button head screw. There is a M6 hex screw hidden between the covers, which must be removed before removing the right cover.
3. Disconnect both O₂ sensors from wiring harness. Remove stock exhaust system and save the hardware. Remove O₂ sensors from the stock headpipes and save for reuse.
4. Remove the stock exhaust mounting bracket and discard. NOTE: The bracket brake line guide must be cut & spread apart so you can remove the brake line from the bracket. Refer to Figure 1.
5. Install the new exhaust mount bracket by inserting the (2) supplied M10 x 45mm allen bolts through the exhaust mount, (2) supplied spacers, frame holes and through the supplied brake-line bracket on the backside; secure the M10 bolts with the (2) supplied nylock hex nuts but **DO NOT TIGHTEN** at this time. Connect the brake hose clip to the bracket using the stock M6 bolt. Refer to Figure 2.
6. Install O₂ sensors into supplied front and rear headpipes. Install the front and rear headpipes onto motorcycle using the supplied flanges, stock bolts and stock nuts. Make sure pipes are parallel to each other and snug but **DO NOT TIGHTEN**.
7. Remove the muffler assembly from the box and slide two supplied 27-61MSC clamps onto the slotted muffler inlet tubes. Refer to Figure 3A for alignment of clamps.
8. Slide the muffler assembly onto the headpipes by tapping on the headpipes with your hand as you push the muffler forward making sure the assembly slides as far forward as possible. Secure the muffler assembly to the exhaust mount bracket using the (2) supplied 5/16-18 bolts but **DO NOT TIGHTEN**.
9. Check the alignment and fitment of all components then tighten the following in order; headpipe flanges to the motor (slowly tighten opposing nuts), exhaust bracket to the frame, muffler assembly to the exhaust bracket, and muffler clamps. (NOTE: If the muffler clamps are slid to far up the muffler or past the slots, the clamps will not tighten properly.)
10. Plug front O₂ sensor connector into stock location. Plug rear O₂ sensor connector into the supplied O₂ sensor harness extension and plug the opposite end into the stock harness location. Make sure the extension harness is tucked inside frame and away from exhaust pipe. Refer to Figure 4.

*** Cobra® recommends you always wear a helmet while riding. Please never operate your motorcycle while under the influence of alcohol and/or drugs. Enjoy the new look of your motorcycle and please ride safely.**

11. Unscrew the hose clamps and feed the tail end of the clamp through the clips on the inside of the heatshields, the larger clamps go to the rear of the heatshields where they will rest on the muffler bodies, smaller ones to the front for the headpipes. The screw end of the hose clamp should be accessible for tightening but not visible when the heatshields are mounted to the pipes. Figure 3B
12. To install the front heatshield, first slide the rear portion of the heatshield over the muffler, continue to slowly slide it forward pushing the front of the shield gently into place between the frame and motor (Hint: Spread the hose clamps apart slightly to make it easier to slide them over the muffler assembly and headpipes). Make sure the muffler clamps don't interfere with the heatshields and are aligned as shown in Figure 3A. Snug the heatshield clamps but **DO NOT TIGHTEN**.
13. Install the rear heatshield the same way as the front heatshield.
14. Make sure heatshields are aligned properly and centered on the headpipes, then tighten the clamps on the heatshields.
15. Reinstall the left and right covers, replace the seat and retighten the floorboard mount loosened in Steps 1 and 2.
16. Make sure all the hardware (brackets, headpipes, heatshields, mufflers and baffles) has been tightened appropriately and cleaned before starting your motorcycle.

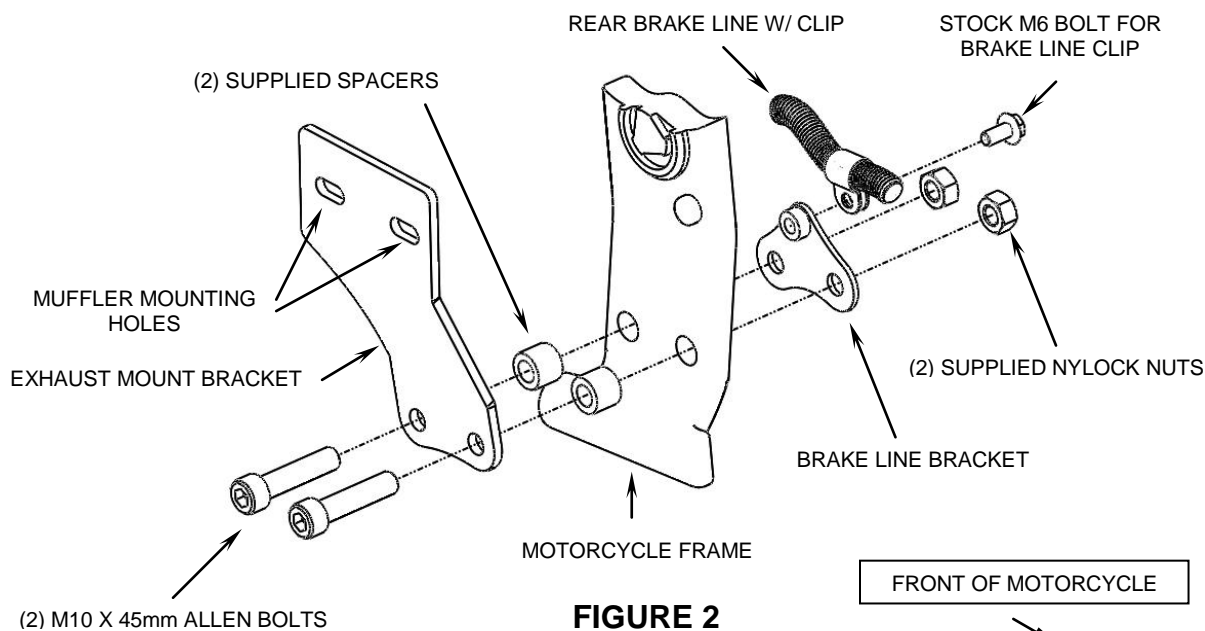
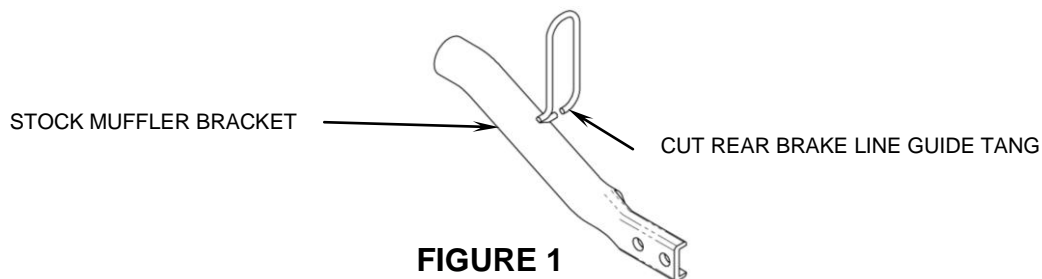

ORIENTATE MUFFLER CLAMPS
AS SHOWN

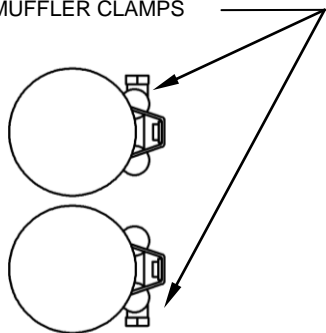

FIGURE 3A

ORIENTATE HEATSHIELD
CLAMPS AS SHOWN

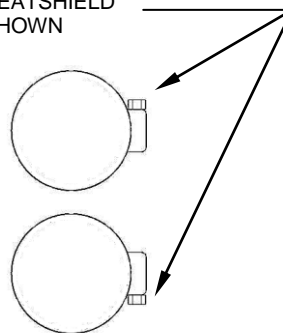

FIGURE 3B

FRONT VIEW

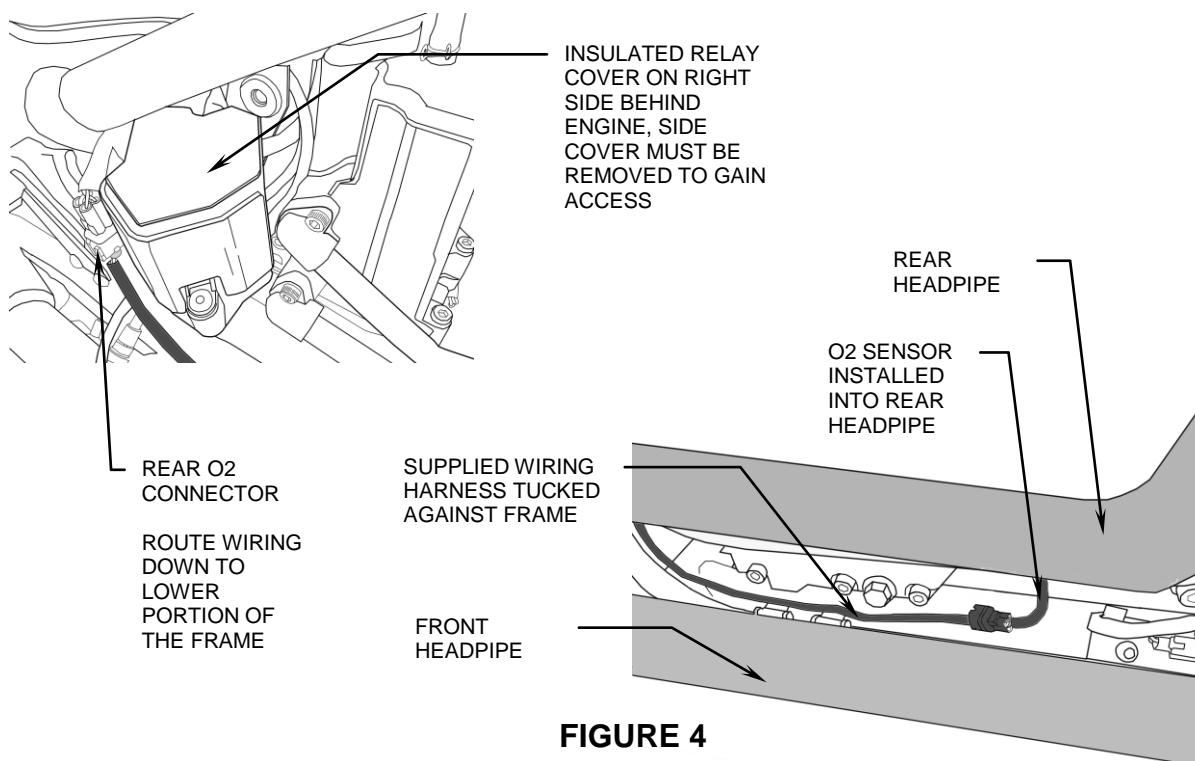

FIGURE 4

IMPORTANT: Cobra highly recommends using a Fi2000® Fuel Management System to help eliminate lean conditions and popping sounds. Cobra Part# 92-1771CL for Fi2000 closed loop. For California models only use Part# 92-1771CL-50

Before starting your engine remove all fingerprints from chrome with a quality wax or chrome polish.

California does not allow the use of aftermarket exhaust systems that remove original equipment catalysts, (except for racing use only) unless the Air Resources Board has issued an Executive Order for that system.