

## Items Supplied >

- 2 – Assembled Floorboards with Mounts
- 2 – Bolt, Flanged Hex M6 X 35mm with Loctite
- 2 – Nut, Hex Nylock M6
- 2 – Washer, Flat 6mm Stainless

## Application(s) >

HONDA VT1300CR / CS 2010-2014  
SABRE / STATELINE

## Instruction Manual >

06-4634

Page 1 of 1

**Your passenger floorboards will install in just a few minutes using common tools. Read all instructions carefully and completely before installing your new passenger floorboards.**

1. Unbolt the (2) M8 bolts on the inside of the **LEFT** frame rail which will allow you to remove footpeg mount bracket. Remove the cotter and clevis pin then remove the stock footpeg.
2. Install the supplied passenger floorboard and aluminum mount onto the unbolted left footpeg mount bracket by inserting the supplied M6 x 35 mm bolt through the top side of footpeg mount bracket, aluminum floorboard mount, supplied M6 washer and nylock nut, but do not fully tighten at this time, see diagram below.
3. Reverse the order of removal and reinstall the footpeg mount bracket. Tighten all bolts securely to factory torque specifications.
4. Align the floorboard's aluminum mount so the floorboard is positioned with a slight angle upward when folded down flat, as shown in Figure 1. Tighten the M6 Nylock nut securely.

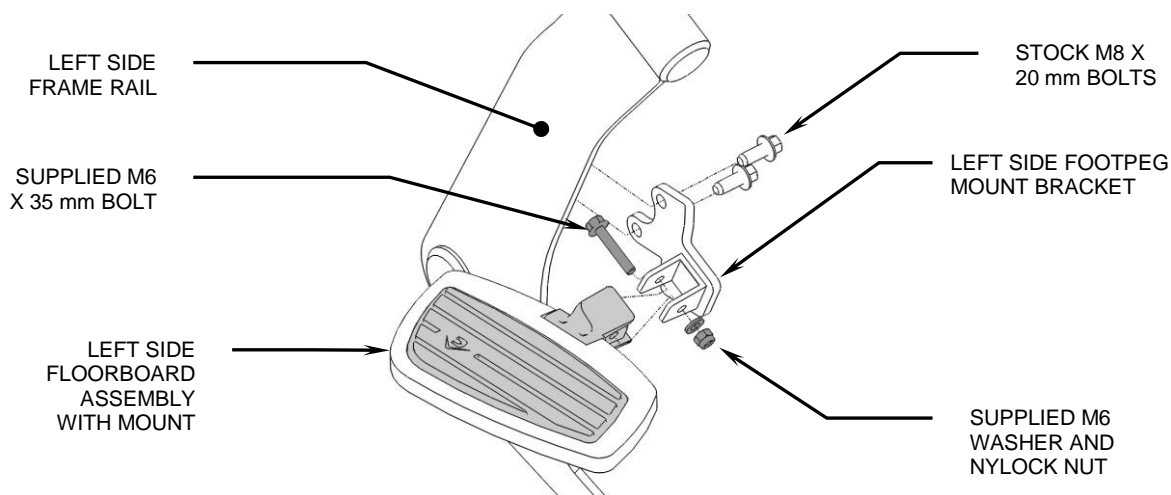

5. On the **RIGHT** side it is **not** necessary to remove the footpeg mount bracket. Simply remove the stock footpeg and install the floorboard in the same manner as Step 2. Perform Step 4 for alignment on the right side before tightening the M6 nut.

**\* Cobra recommends you always wear a helmet while riding. Please never operate your motorcycle while under the influence of alcohol and/or drugs. Enjoy the new look of your motorcycle and please ride safely.**