

Items Supplied >

- 1 – LEFT SIDE CASE GUARD
- 1 – RIGHT SIDE CASE GUARD
- 2 – CLAMP, TUBE FRAME, ALUMINUM
- 2 – M10 x 80mm HEX FLANGE BOLT
- 2 – M10 x 90mm HEX FLANGE BOLT
- 2 – M8 x 16mm BUTTONHEAD BOLT

Application(s) >

YAMAHA STRYKER 2011-2015

Instruction Manual >

01-3270

Page 1 of 1

Read all instructions carefully before installing your new Cobra® product!

1. Remove the (2) bolts securing the left side rider footpeg assembly; these bolts will not be used again.
2. Position the left case guard bracket in-between the footpeg mount and the frame. Then insert the (2) supplied M10 x 80mm hex bolts through the stock footpeg mount, case guard bracket and begin threading into the frame until snug but **DO NOT TIGHTEN**. See Figure 1.
3. Remove the (2) bolts securing the right side rider footpeg assembly; these bolts will not be used again.
4. Position the right case guard bracket on the outside of the footpeg mount. Then insert the (2) supplied M10 x 90mm hex bolts through the case guard bracket and footpeg mount and begin threading into the frame until snug but **DO NOT TIGHTEN**. See Figure 2.
5. Position the aluminum clamps around the frame down tubes and secure the upper portion of the case guards and each clamp with the (2) supplied M8 x 16mm bolts as shown in Figures 1 & 2.
6. Align and level case guards then fully tighten the the M8 bolts securing the clamps followed by the (4) supplied M10 bolts to factory specification.

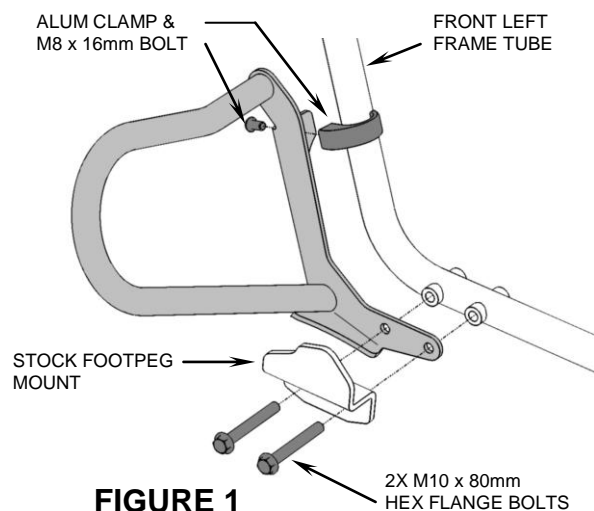

FIGURE 1
(LEFT SIDE SHOWN)

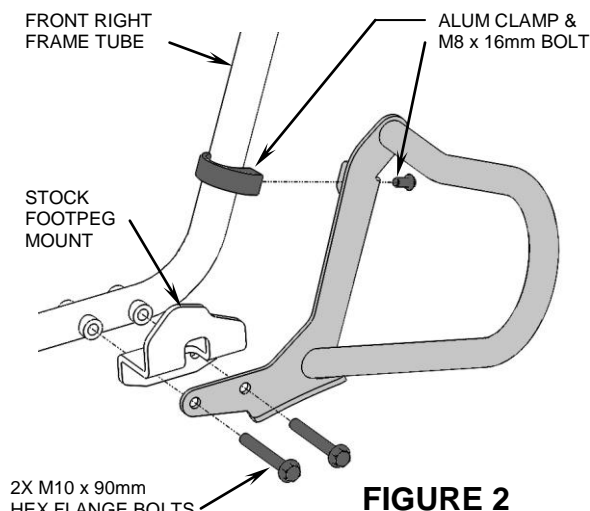

FIGURE 2
(RIGHT SIDE SHOWN)

STOCK FOOTPEG MOUNTS HAVE BEEN SIMPLIFIED FOR DIAGRAM CLARITY

* **Cobra® recommends you always wear a helmet while riding. Please never operate your motorcycle while under the influence of alcohol and/or drugs. Enjoy the new look of your motorcycle and please ride safely.**